

## Serie KME Accesorios metálicos

SA011

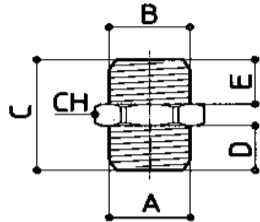

Unión macho-macho rosca cilíndrica BSPP

Cod.	Referencia	A	B	C	D	E	CH
00120501	KME-UMM-P-M5	M5	M5	12	4	4	8
00120498	KME-UMM-P-M5-18	M5	1/8	15	4,5	6	14
00120482	KME-UMM-P-18	1/8	1/8	16,5	6	6	14
00120478	KME-UMM-P-18-14	1/8	1/4	19	6	8	17
00120486	KME-UMM-P-18-38	1/8	3/8	20	6	9	19
00937848	KME-UMM-P-18-12	1/8	1/2	22	6	10	24
00120469	KME-UMM-P-14	1/4	1/4	21	8	8	17
00120473	KME-UMM-P-14-38	1/4	3/8	22	8	9	19
00120466	KME-UMM-P-14-12	1/4	1/2	24	8	10	24
00120942	KME-UMM-P-14-34	1/4	3/4	25	8	11	30
00120494	KME-UMM-P-38	3/8	3/8	24	9	9	19
00120490	KME-UMM-P-38-12	3/8	1/2	25	9	10	24
01111161	KME-UMM-P-38-34	3/8	3/4	27	9,5	11	30
00120462	KME-UMM-P-12	1/2	1/2	26	10	10	24
00442262	KME-UMM-P-12-34	1/2	3/4	28	10	11	30
00970456	KME-UMM-P-12-10	1/2	1"	36	11	15	36
00510002	KME-UMM-P-34	3/4	3/4	29	11	11	30
01111163	KME-UMM-P-34-10	3/4	1"	28	11,5	13	30
00668267	KME-UMM-P-10	1"	1"	33	13	13	36
00852639	KME-UMM-P-114	1"1/4	1"1/4	39	15	15	48

SA012

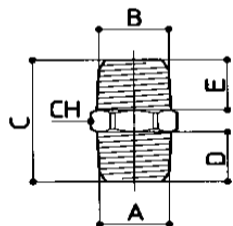

Unión macho-macho rosca cónica BSPT

Cod.	Referencia	A	B	C	D	E	CH
00120529	KME-UMM-C-18	1/8	1/8	20	8	8	12
00120525	KME-UMM-C-18-14	1/8	1/4	23	8	11	14
00120532	KME-UMM-C-18-38	1/8	3/8	24	8	11	17
00311238	KME-UMM-C-38-34	3/8	3/4	32	11,5	14	27
00120518	KME-UMM-C-14	1/4	1/4	26	11	11	14
00120522	KME-UMM-C-14-38	1/4	3/8	27	11	11	17
00120514	KME-UMM-C-14-12	1/4	1/2	32	11,5	14	22
00833948	KME-UMM-C-14-34	1/4	3/4	32	11,5	14	27
00120543	KME-UMM-C-38	3/8	3/8	28	11,5	11,5	17
00120539	KME-UMM-C-38-12	3/8	1/2	32	11,5	14	22
00120505	KME-UMM-C-12	1/2	1/2	33,5	14	14	22
00120510	KME-UMM-C-12-34	1/2	3/4	35	14	14	27
00120536	KME-UMM-C-34	3/4	3/4	35	16,5	16,5	27
00412422	KME-UMM-C-34-10	3/4	1"	38	14	16	36
00120454	KME-UMM-C-10	1"	1"	38	16	16	36
00309469	KME-UMM-C-114-112	1"1/4	1"1/2	53	20	23	54

SA013

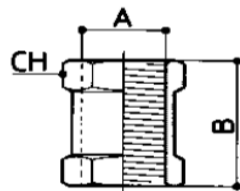

Unión hembra-hembra rosca cilíndrica BSPP

Cod.	Referencia	A	B	C	CH
00119312	KME-UHH-P-M5	M5	M5	11	8
00119304	KME-UHH-P-18	1/8	1/8	15	14
00119300	KME-UHH-P-14	1/4	1/4	22	17
00119308	KME-UHH-P-38	3/8	3/8	23	22
00119296	KME-UHH-P-12	1/2	1/2	30	25
00722186	KME-UHH-P-34	3/4	3/4	29	32
00911784	KME-UHH-P-10	1"	1"	32	38

SA018

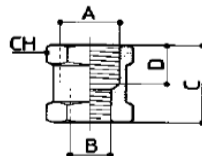

Prolongación hembra-hembra rosca cilíndrica BSPP

Cod.	Referencia	A	B	C	D	CH
00119334	KME-RHH-P-M5-18	1/8	M5	13	4	14
00119323	KME-RHH-P-18-14	1/4	1/8	22	10	17
00119327	KME-RHH-P-18-38	3/8	1/8	20	-	22
00119319	KME-RHH-P-14-38	3/8	1/4	24	12	22
00119315	KME-RHH-P-14-12	1/2	1/4	25,5	-	24
00119330	KME-RHH-P-38-12	1/2	3/8	24	12	25
00911781	KME-RHH-P-12-34	3/4	1/2	26	10	32
00906727	KME-RHH-P-12-10	1"	1/2	26	9	38
00911785	KME-RHH-P-34-10	1"	3/4	26	9	38

## Serie KME Accesorios metálicos

SA014

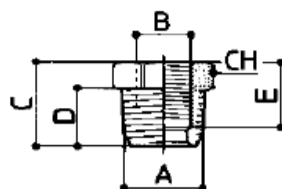

Unión macho-hembra rosca cónica BSPT

Cod.	Referencia	A	B	C	D	E	CH
00907223	KME-RMH-C-18-M5	1/8	M5	12	8	6	12
01045456	KME-RMH-C-18-M6	1/8	M6	12,5	8	8	12
00119885	KME-RMH-C-14-18	1/4	1/8	16	11	8	14
00119897	KME-RMH-C-38-18	3/8	1/8	16,5	11,5	8	17
00119893	KME-RMH-C-38-14	3/8	1/4	16,5	11,5	11	17
00119877	KME-RMH-C-12-18	1/2	1/8	20	14	8	22
00119873	KME-RMH-C-12-14	1/2	1/4	20	14	11	22
00119881	KME-RMH-C-12-38	1/2	3/8	20	14	14	22
00119795	KME-RMH-C-34-38	3/4	3/8	23,5	16	16	27
00119888	KME-RMH-C-34-12	3/4	1/2	23,5	16	16	27
00485589	KME-RMH-C-10-38	1"	3/8	23	-	-	36
00214852	KME-RMH-C-10-12	1"	1/2	23	-	-	36
00215786	KME-RMH-C-10-34	1"	3/4	23	-	-	36
00854568	KME-RMH-C-114-10	1"1/4	1"	29	-	-	44
00785553	KME-RMH-C-20-112	2"	1"1/2	36	-	-	61

SA015

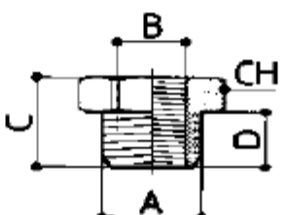

Reducción macho-hembra rosca cilíndrica BSPP

Cod.	Referencia	A	B	C	D	CH
00119862	KME-RMH-P-18-M5	1/8	M5	10,5	6	14
01045448	KME-RMH-P-18-M6	1/8	M6	10,5	6	14
00119858	KME-RMH-P-14-18	1/4	1/8	13	8	17
00119870	KME-RMH-P-38-18	3/8	1/8	14	9	19
00119866	KME-RMH-P-38-14	3/8	1/4	14	9	19
00119850	KME-RMH-P-12-18	1/2	1/8	15,5	10	24
00119846	KME-RMH-P-12-14	1/2	1/4	15,5	10	24
00119854	KME-RMH-P-12-38	1/2	3/8	15,5	10	24
00119901	KME-RMH-P-34-14	3/4	1/4	17,5	11,5	30
00485603	KME-RMH-P-34-38	3/4	3/8	16	11,5	30
00119913	KME-RMH-P-34-12	3/4	1/2	17,5	11,5	30
00920954	KME-RMH-P-10-12	1"	1/2	20	13	36
00971087	KME-RMH-P-10-34	1"	3/4	20	13	36
00309258	KME-RMH-P-112-114	1"1/2	1"1/4	24	16	48

SA016

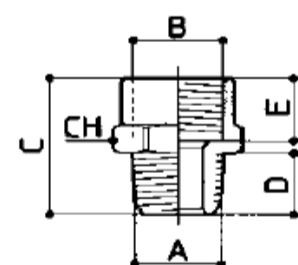

Prolongación macho-hembra rosca cónica BSPT

Cod.	Referencia	A	B	C	D	E	CH
00120562	KME-PMH-C-18	1/8	1/8	18	8	8	14
00120558	KME-PMH-C-18-14	1/8	1/4	21,5	8	11	17
00784097	KME-PMH-C-18-38	1/8	3/8	23	8	12	22
00120550	KME-PMH-C-14	1/4	1/4	24,5	11	11	17
00120554	KME-PMH-C-14-38	1/4	3/8	25,5	11	11,5	22
00119761	KME-PMH-C-14-12	1/4	1/2	28	11	14	24
00120569	KME-PMH-C-38	3/8	3/8	27	12	12	22
00120565	KME-PMH-C-38-12	3/8	1/2	29	12	14	24
00784098	KME-PMH-C-38-34	3/8	3/4	29	10	-	32
00120546	KME-PMH-C-12	1/2	1/2	31,5	14	14	24
00271666	KME-PMH-C-12-34	1/2	3/4	30	12	-	32
00535703	KME-PMH-C-12-10	1/2	1"	31	12	13	38
00975756	KME-PMH-C-34	3/4	3/4	31	13	17	32
00911775	KME-PMH-C-34-10	3/4	1"	32	14	-	38
00699270	KME-PMH-C-10	1"	1"	33	16	-	38

SA017

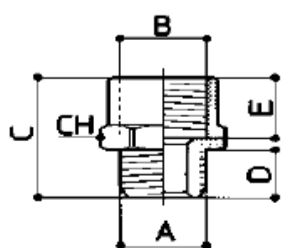

Prolongación macho-hembra rosca cilíndrica BSPP

Cod.	Referencia	A	B	C	D	E	CH
01157596	KME-PMH-P-M5	M5	M5	11	4,5	-	8
00120605	KME-PMH-P-M5-18	M5	1/8	15	5	8	14
00884531	KME-PMH-P-M6-18	M6	1/8	16	6	8	14
00120594	KME-PMH-P-18	1/8	1/8	16	6	8	14
00120589	KME-PMH-P-18-14	1/8	1/4	20,5	6	12	17
00911780	KME-PMH-P-18-38	1/8	3/8	20,5	6	12	22
00120581	KME-PMH-P-14	1/4	1/4	22,5	8	12	17
00120586	KME-PMH-P-14-38	1/4	3/8	23	8	12	22
00120572	KME-PMH-P-14-12	1/4	1/2	25	8	14	24
00120602	KME-PMH-P-38	3/8	3/8	24	9	12	22
00120598	KME-PMH-P-38-12	3/8	1/2	26	9	14	24
00120577	KME-PMH-P-12	1/2	1/2	27	10	14	27
00519126	KME-PMH-P-12-34	1/2	3/4	27	10	14	30
00580618	KME-PMH-P-12-10	1/2	1"	29,5	11	18	38
00519125	KME-PMH-P-34	3/4	3/4	29	11	-	32
00676781	KME-PMH-P-10	1"	1"	30	12	-	38

## Serie KME Accesorios metálicos

SA039

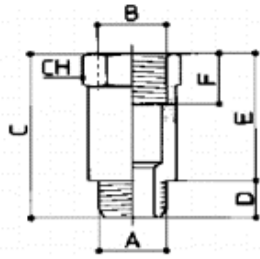

Prolongación larga macho-hembra rosca cilíndrica BSPP

Cod.	Referencia	A	B	C	D	E	F
00120441	KME-PMHL22-C-18	1/8	1/8	22	6	16	8
00120445	KME-PMHL42-C-18	1/8	1/8	42	6	36	8
00210919	KME-PMHL51-C-18	1/8	1/8	51	6	45	8
00119729	KME-PMHL35-C-14	1/4	1/4	35	8	27	11
00120451	KME-PMHL51-C-14	1/4	1/4	51	8	43	11
00546442	KME-PMHL-C-38	3/8	3/8	41	9	32	12
00681034	KME-PMHL36-C-12	1/2	1/2	36	10	26	12
00980055	KME-PMHL-C-34	3/4	3/4	50	12	38	12
00699269	KME-PMHL50-C-10	1"	1"	50	12	38	12

SA019

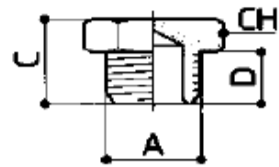

Tapón cabeza hexagonal rosca cónica BSPT

Cod.	Referencia	A	C	D	CH
00120208	KME-TPMX-C-M5	M5	7,5	4	8
00120201	KME-TPMX-C-18	1/8	10,5	6	14
00120197	KME-TPMX-C-14	1/4	13	8	17
00120204	KME-TPMX-C-38	3/8	14	9	19
00120193	KME-TPMX-C-12	1/2	15,5	10	24
00210454	KME-TPMX-C-34	3/4	17	11	30
00911778	KME-TPMX-C-10	1"	18,5	13	36

SA020

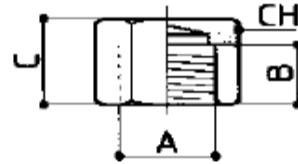
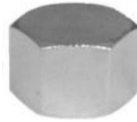

Tapón hexagonal rosca hembra cilíndrica BSPP

Cod.	Referencia	A	B	C	CH
00120185	KME-TPHX-P-18	1/8	8	12	14
00120182	KME-TPHX-P-14	1/4	11	15,5	17
00120189	KME-TPHX-P-38	3/8	11,5	17	20
00120179	KME-TPHX-P-12	1/2	-	14,5	24
00905731	KME-TPHX-P-34	3/4	-	14,5	30

SA043

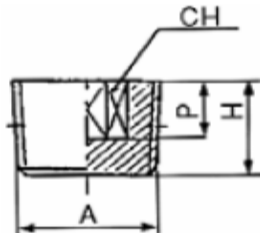

Tapón hexágono interior rosca cónica BSPT

Cod.	Referencia	A	P	H	CH
00120220	KME-TPM-C-18	1/8	3,5	7,7	5
00120216	KME-TPM-C-14	1/4	5	9,5	6
00120224	KME-TPM-C-38	3/8	6,5	10	8
00120212	KME-TPM-C-12	1/2	-	13	10

SA049

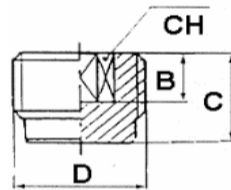

Tapón hexágono interior rosca cilíndrica BSPP

Cod.	Referencia	D	B	C	CH
00120227	KME-TPM-P-18	1/8	3,5	7	5
00175833	KME-TPM-P-14	1/4	5	10	6
01063032	KME-TPM-P-12	1/2	-	13	10

SA033

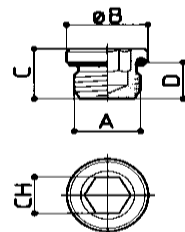

Tapón hexágono interior con junta rosca cilíndrica BSPP

Cod.	Referencia	A	B	C	D	CH
01017157	KME-TPMJ-P-M5	M5	8	6	4	2,5
00442881	KME-TPMJ-P-18	1/8	13	9	6	6
00442882	KME-TPMJ-P-14	1/4	16	11	8	8
00442883	KME-TPMJ-P-38	3/8	20	14	10	10
00442884	KME-TPMJ-P-12	1/2	25	16	12	12

SA021

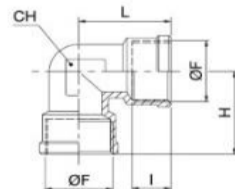

Codo igual rosca hembra cilíndrica BSPP

Cod.	Referencia	A	B	C	E	CH
01013559	KME-CHH-P-18	1/8	1/8	18,5	8	10
01013558	KME-CHH-P-14	1/4	1/4	22,5	11,5	13
01013563	KME-CHH-P-38	3/8	3/8	25,5	11,5	17
01013556	KME-CHH-P-12	1/2	1/2	30	14	21
01012492	KME-CHH-P-34	3/4	3/4	34	17	27
00676782	KME-CHH-P-10	1"	1"	45	21	30

SA022

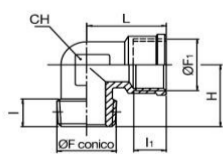

Codo rosca macho cónica BSPT-hembra cilíndrica BSPP

Cod.	Referencia	F	F1	I	I1	H	L
00677766	KME-CMH-CF-M5	M5	M5	-	4	11	11,5
01014244	KME-CMH-CF-18	1/8	1/8	8	8	18,5	34
01013567	KME-CMH-CF-14	1/4	1/4	11	11	22,5	45
01014254	KME-CMH-CF-38	3/8	3/8	12,5	11,5	25,5	51
01013565	KME-CMH-CF-12	1/2	1/2	14,5	14	30	60
01014253	KME-CMH-CF-34	3/4	3/4	17	16,5	35,5	69



## Serie KME Accesorios metálicos

SA035

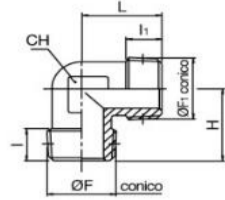

Codo igual rosca macho cónica BSPT

Cod.	Referencia	F	F1	I	I1	H	L
01014505	KME-CMM-C-18	1/8	1/8	8	8	17	17
01014506	KME-CMM-C-14	1/4	1/4	11,5	11,5	22,5	22,5
01014507	KME-CMM-C-38	3/8	3/8	12,5	12,5	25,5	25,5
01014508	KME-CMM-C-12	1/2	1/2	14	14	30	30
00118482	KME-CMM-C-34	3/4	3/4	17	-	33	33
01014509	KME-CMM-C-10	1"	1"	18,5	18,5	40,5	40,5

SA027

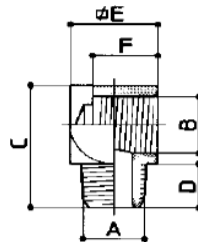

Codo reducido macho-hembra rosca cónica BSPT

Cod.	Referencia	A	B	C	D	E
00238158	KME-CRMH-C-M5	M5	M5	16	5	9
00118439	KME-CRMH-C-18	1/8	1/8	22	8	14
00118434	KME-CRMH-C-14	1/4	1/4	28	10	-

SA028

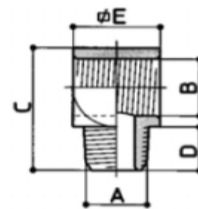

T central reducida macho-hembra-hembra rosca cónica BSPT

Cod.	Referencia	A	B	C	D	E	F
00120094	KME-TRMHH-C-18	1/8	14	22	8	1/8	8
00120090	KME-TRMHH-C-14	1/4	18	28	10	1/4	10

SA023

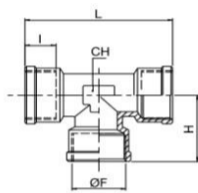

T central hembra-hembra-hembra rosca cilíndrica BSPP

Cod.	Referencia	F	I	H	L	CH
01014490	KME-TH-P-18	1/8	8	18,5	37	10
01014489	KME-TH-P-14	1/4	11	22,5	45	12
01014492	KME-TH-P-38	3/8	11,5	25,5	51	15
01014488	KME-TH-P-12	1/2	14	30	60	19
01014491	KME-TH-P-34	3/4	16,5	35,5	71	22
00519124	KME-TH-P-10	1"	21	45	90	30

SA024

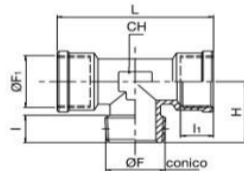

T central macho-hembra-hembra rosca cónica BSPT

Cod.	Referencia	F	F1	I	I1	H	L
01014496	KME-TMHH-C-18	1/8	1/8	8	8	17	37
01014495	KME-TMHH-C-14	1/4	1/4	11,5	11	22,5	45
01014498	KME-TMHH-C-38	3/8	3/8	12,5	11,5	25,5	51
01014494	KME-TMHH-C-12	1/2	1/2	14,5	14	30	60
01014497	KME-TMHH-C-34	3/4	3/4	17	16,5	34,5	71
01014493	KME-TMHH-C-10	1"	1"	19	18	40,5	81

SA025

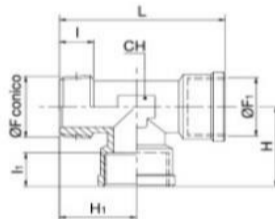

T lateral macho-hembra-hembra rosca cónica BSPT

Cod.	Referencia	F	F1	I	I1	H	H1
01014502	KME-TLMHH-C-18	1/8	1/8	8	8	18,5	17
01014501	KME-TLMHH-C-14	1/4	1/4	11,5	11	22,5	22,5
01014504	KME-TLMHH-C-38	3/8	3/8	12,5	11,5	25,5	22,5
01014500	KME-TLMHH-C-12	1/2	1/2	14,5	14	30	30
01014503	KME-TLMHH-C-34	3/4	3/4	17,5	16,5	35,5	34,5
01014499	KME-TLMHH-C-10	1"	1"	19	18	40,5	40,5

SA031

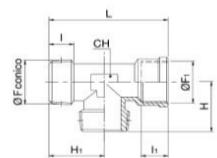

T central macho-macho-hembra rosca cónica BSPT

Cod.	Referencia	A	B	F	CH
00896999	KME-TLHMM-C-14	1/4	1/4	11	13
00897001	KME-TLHMM-C-38	3/8	3/8	11,5	17

SA036

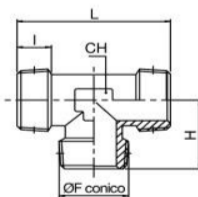

T central macho-macho-macho rosca cónica BSPT

Cod.	Referencia	F	I	H	L	CH
01014510	KME-TM-C-18	1/8	8	17	34	10
01014511	KME-TM-C-14	1/4	11,5	22,5	45	12
01014512	KME-TM-C-38	3/8	12,5	25,5	51	15
01014513	KME-TM-C-12	1/2	14,5	30	60	19
01014514	KME-TM-C-34	3/4	17	34,5	69	22
00762440	KME-TM-C-10	1"	-	39	78	30

SA045

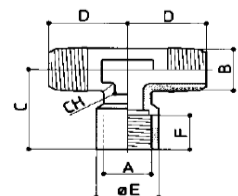

T central macho-macho-hembra rosca cónica BSPT

Cod.	Referencia	A	B	C	D	F	CH
00484268	KME-THMM-C-18	1/8	1/8	21	18,5	8	10
00126346	KME-THMM-C-14	1/4	1/4	25,5	23,5	11	13
01009700	KME-THMM-C-38	3/8	3/8	28	26	11,5	17
00137161	KME-THMM-C-12	1/2	1/2	33,5	31	14	21
00535704	KME-THMM-C-10	1"	1"	-	-	-	-

## Serie KME Accesorios metálicos

SA026

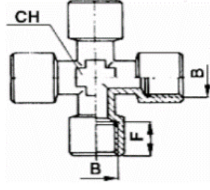

Cruz intermedia hembra rosca cilíndrica BSPP

Cod.	Referencia	B	F	CH
00118723	KME-CRH-P-18	1/8	8	10
00118720	KME-CRH-P-14	1/4	11	13
00118727	KME-CRH-P-38	3/8	11,5	17
00741097	KME-CRH-P-12	1/2	14	21

SA032

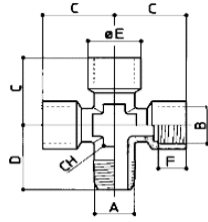

Cruz macho-hembra-hembra-hembra rosca cilíndrica BSPP

Cod.	Referencia	A	B	C	D	F	CH
00845356	KME-CRHM-C-18	1/8	1/8	18,5	18,5	8	10
00845349	KME-CRHM-C-14	1/4	1/4	23,5	23,5	11	13
00845357	KME-CRHM-C-38	3/8	3/8	26	26	11,5	17
00214675	KME-CRHM-C-12	1/2	1/2	31	31	14	21

SA029

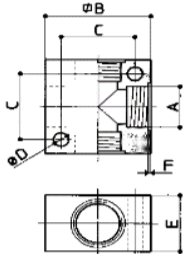

Repartidor en cruz rosca hembra cilíndrica BSPP

Cod.	Referencia	A	B	C	D	E	Material
00118889	KME-DCRH-P-M5	M5	20	14	3,2	10	Aluminio
00118881	KME-DCRH-P-18	1/8	25	-	4,5	16	Aluminio
00118877	KME-DCRH-P-14	1/4	40	-	5,5	20	Aluminio
00118885	KME-DCRH-P-38	3/8	50	34	5,5	25	Aluminio
00118873	KME-DCRH-P-12	1/2	50	34	5,5	30	Aluminio
00443068	KME-DCRH-P-34	3/4	60	45	5,5	35	Aluminio

SA040

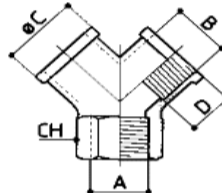

Repartidor en Y hembra rosca cónica BSPT

Cod.	Referencia	A	B	CH
00120820	KME-YH-P-18	1/8	1/8	13
00120816	KME-YH-P-14	1/4	1/4	17
00120824	KME-YH-P-38	3/8	3/8	20
00120813	KME-YH-P-12	1/2	1/2	25

SA041

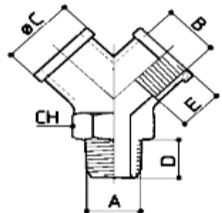

Repartidor en Y macho-hembra-hembra rosca cónica BSPT

Cod.	Referencia	A	B	D	E	CH
00120835	KME-YMH-C-18	1/8	1/8	8	8	13
00120832	KME-YMH-C-14	1/4	1/4	11	11	17
00512751	KME-YMH-C-38	3/8	3/8	11,5	11,5	20
00120828	KME-YMH-C-12	1/2	1/2	14	14	25

SA030

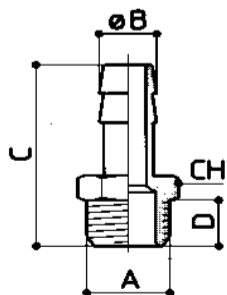

Espiga rosca macho cilíndrica BSPP

Cod.	Referencia	A	B	C	D	CH
00119000	KME-ESPM-P-2.5-M5	M5	2,5	16	5	8
00119005	KME-ESPM-P-4-M5	M5	4	16	5	8
00784099	KME-ESPM-P-6-18	1/8	6	29,5	6	12
00119032	KME-ESPM-P-7-18	1/8	7	29,5	6	12
00119013	KME-ESPM-P-8-18	1/8	8	29,5	6	12
00119020	KME-ESPM-P-9-18	1/8	9	29,5	6	12
00784100	KME-ESPM-P-10-18	1/8	10	30,5	6	12
00784101	KME-ESPM-P-6-14	1/4	6	32	8	14
00119009	KME-ESPM-P-7-14	1/4	7	32	8	14
00933839	KME-ESPM-P-8-14	1/4	8	32	8	14
00119017	KME-ESPM-P-9-14	1/4	9	32	8	14
00784094	KME-ESPM-P-10-14	1/4	10	33	8	14
00118987	KME-ESPM-P-12-14	1/4	12	33	8	14
00933831	KME-ESPM-P-8-38	3/8	8	33	9	19
00119025	KME-ESPM-P-9-38	3/8	9	33	9	19
00784095	KME-ESPM-P-10-38	3/8	10	34	9	19
00118990	KME-ESPM-P-12-38	3/8	12	34	9	19
00784091	KME-ESPM-P-16-38	3/8	16	38	9	19
00118996	KME-ESPM-P-17-38	3/8	17	38	9	19
00933838	KME-ESPM-P-8-12	1/2	8	42	10	24
00933836	KME-ESPM-P-10-12	1/2	10	42	10	24
00118983	KME-ESPM-P-12	1/2	12	35,5	10	22
00312028	KME-ESPM-P-14-12	1/2	14	33	8	14
00784092	KME-ESPM-P-16-12	1/2	16	42	10	24
00118993	KME-ESPM-P-17-12	1/2	17	39,5	10	22
00947021	KME-ESPM-P-20-12	1/2	20	39,5	10	22
00485579	KME-ESPM-P-18-34	3/4	18	42	10	30
00688446	KME-ESPM-P-20-34	3/4	20	47	12	30
00784093	KME-ESPM-P-25-34	3/4	25	53	12	30
00938079	KME-ESPM-P-20-10	1"	20	-	-	-
00718836	KME-ESPM-P-25-10	1"	25	59	11	28
00851567	KME-ESPM-P-30-10	1"	30	-	-	-

## Serie KME Accesorios metálicos

SA054

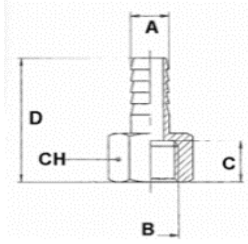

Espiga rosca hembra rosca cilíndrica BSPP

Cod.	Referencia	A	B	C	D	CH
00669701	KME-ESPH-P-8-14	8	1/4	11	33	17
00669704	KME-ESPH-P-10-14	10	1/4	11	35	17
00519130	KME-ESPH-P-12-38	12	3/8	12	36	19
00669716	KME-ESPH-P-14-38	14	3/8	12	38	19
00653565	KME-ESPH-P-12	12	1/2	14	42	24
00519131	KME-ESPH-P-13-12	13	1/2	-	-	-
00669719	KME-ESPH-P-14-12	14	1/2	14	42	24

SA060

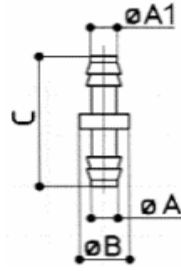

Espiga intermedia

Cod.	Referencia	A	A1	B	C	Gr
00899445	KME-ESPU-3	3	3	6	20	2
00899447	KME-ESPU-3-4	4	3	7	21	2
00120159	KME-ESPU-4	4	4	7	22	3
00465402	KME-ESPU-4-6	6	4	9	22	3
00465403	KME-ESPU-6	6	6	9	22	3

SA044

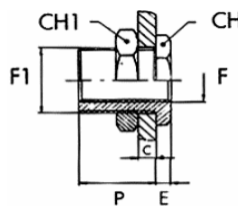

Pasamuros rosca cilíndrica BSPP

Cod.	Referencia	F	F1	C	P	E	CH
00518894	KME-PSM-P-M5	M5	M10x1	7	10,5	3,5	14
00518900	KME-PSM-P-18	1/8	M16	10	14	4	19
00518901	KME-PSM-P-14	1/4	M20	16	21	4	24
00518902	KME-PSM-P-38	3/8	M26	15	21	5	30
00518903	KME-PSM-P-12	1/2	M28	21	27	6	32

RAN



Silenciador interior

Cod.	Referencia	Conexión
00120003	KME-SILINT-18	1/8
00407407	KME-SILINT-14	1/4
00723917	KME-SILINT-38	3/8
00723919	KME-SILINT-12	1/2

RAN



Silenciador exterior

Cod.	Referencia	Conexión
00120019	KME-SILEXT-18	1/8
00120015	KME-SILEXT-14	1/4
00120024	KME-SILEXT-38	3/8
00120011	KME-SILEXT-12	1/2

SV26

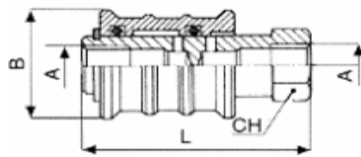

Válvula corredera manual 3/2 vías

Cod.	Referencia	Conexión
00120713	KME-VMC32-18	1/8
00120709	KME-VMC32-14	1/4
00120716	KME-VMC32-38	3/8
00120705	KME-VMC32-12	1/2

Cod.	Referencia	A	B	L	CH
00120713	KME-VMC32-18	1/8	28	53	17
00120709	KME-VMC32-14	1/4	30	58	19
00120716	KME-VMC32-38	3/8	35	68	22
00120705	KME-VMC32-12	1/2	40	80	27